

# SUDBROOKE NEWS

SEPTEMBER 2019



**VILLAGE  
SIGN  
STANDS  
PROUD**

Read the full story  
inside, pages 10-11

**AUTUMN  
SHOW**

Show off your  
gardening, culinary  
and artistic skills,  
pages 3, 14-15

# EDITOR'S RAMBLINGS

SEPTEMBER 2019

HERE we are again, lamenting the end of another summer, wondering why it passed us by so quickly (again). It didn't seem long ago that we were changing the clocks forward, now we will be counting the days down to switching them back.

By the time the clocks change, we could have had another General Election, with the Brexit shenanigans continuing to dominate our daily lives with Prime Minister Boris Johnson (is he really the leader of our country?) threatening this, that and the other. My family and I were in holiday in Denmark recently and some Danes were fascinated by Brexit and were keen to hear what our views were. Interesting that some of them think it will affect them greatly if we do indeed leave.

Anyway, it is great to see the village sign finally erected, while the Gardening Club will be hoping for a bumper turnout for this month's Spring Show. Summer's gone. **Dom**

## OCTOBER ISSUE - DEADLINE FOR CONTRIBUTIONS: SEP 20

### EDITOR & ADVERTISING MANAGER

Dominic Picksley  
Telephone: 01522 595705  
[sudbrookeneews@gmail.com](mailto:sudbrookeneews@gmail.com)

### DISTRIBUTION

Andrew Cottam  
Telephone:  
01522 750470



**CLEARVIEW**  
OPTICIANS

- Private and NHS eye tests
- Contact lens trials & aftercare
- Free parking
- Free\* tests for under 16's & over 60's  
(\* NHS only)

Annabelle Magee BSc(Hons) McOptom

169 Burton Road, Lincoln LN1 3LW

Telephone: 01522 542121

[www.clearviewopticians.co.uk](http://www.clearviewopticians.co.uk)

Email: [enquiries@clearviewopticians.co.uk](mailto:enquiries@clearviewopticians.co.uk)

# PAWSITIVE PET SITTING

Dog Walking \* Pet Sitting  
Cats, Dogs & Small Animals catered for  
DBS Checked, Insured, Dedicated &  
Experienced



Animal Aiders  
First Aid For Animals

Contact Jayne Haley on 01522 752629  
or [info@pawsitive-pet-sitting.co.uk](mailto:info@pawsitive-pet-sitting.co.uk)

[www.pawsitive-pet-sitting.co.uk](http://www.pawsitive-pet-sitting.co.uk)



# AUTUMN SHOW

Vegetables, fruit, flowers, jams, scones, flans, foliages, crafts and much more

## WHAT WILL YOU BRING?

### Hello Sudbrooke Villagers!

Each year there are two village shows in the Village Hall which are open for entries from **ALL** villagers. The shows are run by members of the Sudbrooke Gardening Club. Even if you do not enter any exhibits, it is worth a visit to see the array of entries of flowers, vegetables, photography, crafts and baking.

We would **LOVE** more support and entries from village residents and you will receive a very warm welcome... so why not come along with your longest bean or the cuddly toy that you made for the children.

Perhaps try your hand in the baking classes or bring along a favourite photo that sums up 'In the garden' for you. It doesn't have to be in a frame... just print it out and bring it along! If you have children or grandchildren, then we would love to have entries from them as well.

It is totally free for children to enter and they will all get a certificate and some sweets. There is a first and second prize

awarded by the judges in the junior section as well as a trophy for the adjudged junior winner, which they can keep until the next show.

Adult entries are 20p per item to help defray the cost of hiring the hall, providing raffle prizes, sweets for the children, printing the award certificates and the

prizes etc. Adults have the opportunity of winning prizes as well as our two trophies - one for 'Best in Show' and the other for 'Overall Winner' (again, retained until the next show).

The Autumn Show is on Monday, 9 September commencing at 6pm. So why not pop along for the public viewing at 7.45pm, buy a cuppa for 50p (with free refills!), meet up with other residents and stay for the presentation of prizes and trophies.

The Rules and Schedule of Entries can be found on pages 14-15 and will also be published in the September issue of this magazine.

Come on... **WHAT WILL YOU BRING?**



**John and Iris Whitaker**  
Joint Secretaries

**Coral Evans**  
Chairlady

**SUDBROOKE GARDENING CLUB**

# PARISH COUNCIL MINUTES

JUNE 2019

## Minutes of the monthly meeting of Sudbrooke Parish Council held on Thursday 6 June in the Sudbrooke Village Hall.

### PRESENT

Councillors Peter Heath (Chairman), Bob Waller (Vice Chairman), Andy Cottam, Mrs Lyn Etheridge, Stuart Hewson, Ian Russell, Mike Turnbull, County Councillor Mrs Sue Rawlins, Christine Myers (Clerk), Bridget Solly (Treasurer)

### ■ 37 PARISHIONERS ITEMS

Items had been brought to the attention of the Parish Council as follows:

- ▶ Parking problems on Beresford Drive, along with possibility of a business being conducted. That the Police be notified and advice sought from WLDC unanimously Resolved.
- ▶ Damage to a fence on West Drive had occurred - Police were aware.
- ▶ Request for footpath and sweep around the Church - Clerk to organise with WLDC Street Team.
- ▶ A resident had expressed concern about potholes on West Drive caused by construction traffic.
- ▶ An overgrown hedge was reported on Wragby Road, tree overhanging footway on Holme Drive and hedge overgrown on Church Lane towards junction at Scothern Lane - That the Clerk write to property owners requesting that these be cut back unanimously Resolved.
- ▶ That the grass verge on Wragby Road was encroaching onto the footpath severely affecting the width of the footway in places. That an enquiry be made to the Rapid Relief Team to see if they could cut back the verge unanimously Resolved.

### ■ 38 SIGNATURE OF DECLARATION OF ACCEPTANCE

### OF OFFICE OF VICE CHAIRMAN-COUNCILLOR BOB WALLER

- ▶ Councillor Waller duly signed the Declaration of Acceptance of Office.

### ■ 39 APOLOGIES

- ▶ Councillor Mrs Barbara Bingham - that the reason given be accepted unanimously Resolved.

### ■ 40 DECLARATIONS OF INTEREST

- ▶ None.

### ■ 41 NOTES OF MEETING HELD ON MAY 9 TO BE APPROVED AND SIGNED AS MINUTES

- ▶ That the notes be signed as minutes unanimously Resolved.

## PUBLIC *matters*

READ DISTRICT  
COUNCILLOR  
BOB WALLER'S  
MONTHLY  
UPDATE



PAGE 13

# PARISH COUNCIL MINUTES

JUNE 2019

## ■ 42 POLICE MATTERS

Reports of incidents in Sudbrooke, from May 1-June 4 :

- ▶ May 4 - St Edwards Drive - Alarm, audible only: Neighbours away and house alarm going off.
  - ▶ May 9 - St Edwards Drive - Vehicle Offences: Possible cloned plates.
  - ▶ May 18 - Wragby Road - Traffic Offence - Child not properly restrained in vehicle.
  - ▶ May 20 - Wragby Road - Concern for safety - Male on all four with face near to the found - unsure if he is poorly.
  - ▶ May 30 - Holme Drive - Possible burglary in progress: Householder thinks someone in the garage - all in order - no signs of a break in.
  - ▶ May 31 - Holme Drive - ASB (anti-social behaviour) - Youths causing problems outside the shop.
  - ▶ May 31 - Parklands, West Drive - Criminal Damage: Windows broken in new build properties.
- Please note that not all incidents have been included such as domestics as they are not in the public interest.

## ■ 43 COUNTY COUNCILLOR'S REPORT

▶ CC Mrs Sue Rawlins reported that she had attended the AGM of Lincolnshire County Council on April 17 and gave a brief report of the meeting. She also stated that there was 4M being held in reserves for the highways budget.

## ■ 44 DISTRICT COUNCILLOR'S REPORT

▶ DC Bob Waller stated that in the recent elections the Conservative party had maintained a majority of seats on West Lindsey District Council and that he was now Vice Chairman of the Planning Committee. Councillor Giles McNeill was also the new Leader of WLDC.

## ■ 45 REPORTS ON MATTERS OUTSTANDING

- ▶ a) Fun Day - June 30: A Councillor would be in attendance at the Fun Day, this to be arranged between members.
- ▶ b) Pruning of Beech Trees, Beech Tree corner: As no response had been received from the owners of the trees that an inspection of the trees be made by the WLDC Trees Officer. Unanimously Resolved.
- ▶ c) Siting of Village Sign: A quotation had been received from a local company who had demonstrated capability for siting the sign in the Jubilee Garden. Due to the problems encountered in appointing a company to site the sign that this quotation be accepted in the sum of £920.00 unanimously Resolved.
- ▶ d) Fitting of gate at new sportsfield - Two quotations received: Company (a) in the sum of £917.00, Company (b) in the sum of £800.00. That quotation (b) be accepted unanimously Resolved.

## ■ 46 REVIEW OF POLICIES

- ▶ a) Communications Protocol - Reviewed without amendment. Unanimously Resolved.
- ▶ b) Complaints Procedure - a new Complaints Procedure was discussed and that it be adopted. Unanimously Resolved.

# PARISH COUNCIL MINUTES

JUNE 2019

## ■ 47 PLANNING MATTERS

► a) Park development: A progress report on road access from Holme Drive and the potential opening of the pathway from Main Drive had been received. However, a number of residents had approached the Parish Council with requests for information due to the increased traffic flow down Holme Drive relating to the Parklands Development, the PC having only the original Traffic Management Plan produced for the original CDM Construction Phase Plan for the project which does not include Home Drive.

It was noted also that the site entrance to the Parklands appears to not have anyone controlling it being open all day for anyone to enter posing a safety risk. That the Parish Council request a copy of the latest revision of the Traffic Management Plan and an indication of how this may develop as the access from Holme Drive, unanimously Resolved.

► b) Application 139392 - 91 Wragby Road: side and rear extension together with replacement garage roof. No objections by Parish Council.

► c) Application 139357 - The Old Apiary, Wragby Road: Comments submitted to WLDC by Clerk following circulation of plans to members - No objections.

► d) Renovated property, Manor Drive: WLDC Planning Enforcement had sent a report as follows: "We have investigated this property and are monitoring the site. We have been informed that the house has been purchased by a company for people to live independently alongside a care package. Providing there are no more than

six people and they are living in the house as one, for example eating, cooking and using the facilities as a family then planning permission would not be required. If they were in effect renting a room or living in connection with a HMO arrangement then planning would be required."

## ■ 48 FINANCIAL MATTERS

► a) Parish Council Risk Assessment Review: Reviewed without amendment - unanimously Resolved.

► b) Comments from Internal Auditor: Request from Internal Auditor to include salaries as a collective figure in the accounts for payment. This would be included.

► c) Fixed Asset Register: This was reviewed with amendments.

► d) Accounts to be paid:-  
e.on - electricity account £11.58  
Parish Magazine Printing

**Sudbrooke News** £275.88

Glendale Countryside Ltd - May cut  
Net £554.56, VAT £110.91, Gross - £665.47  
LALC Two copies of Good Councillors Guide for new councillors £7.00

G Cullen - repair and varnishing of Park Gates noticeboard £85.00

Mrs C Myers - expenses May £43.78

Lynx Outdoor Products - two benches  
Net - £690.00, VAT £138.00, Gross £828.00

That the above payments be made - Unanimously Resolved.

# PARISH COUNCIL MINUTES

JUNE 2019

## ■ 49 CLERK'S REPORT

- ▶ The Clerk reported that the new seats had been fitted to the front of the Village Hall.
- ▶ That those Councillors who had undergone First Aid training in 2016 would be requiring training again this year. Members instructed the Clerk to arrange a further course.
- ▶ The Village Hall Committee would be meeting on June 12 - PC members had no items to be brought to the VH Committee's attention.
- ▶ That the Clerk would be unavailable to attend the PC meeting on September 5 2019.
- ▶ Members agreed re-scheduled date of September 12 - unanimously Resolved.

## ■ 50 CHAIRMAN'S COMMENTS

- ▶ The Chair drew attention to children being at home during the school holidays and out and about around the village. He requested that parents advise their youngsters on the community spirit in the village and that they not cause mischief for other residents.
- ▶ Agenda item for next meeting - Formal Entrance for pedestrians - New Sportsfield, Scothern Lane.
- ▶ It was noted that the seat to the rear of the Village Hall, overlooking the children's

play area was in need of repair or replacement - agenda item for next meeting.

- ▶ Councillor Stuart Hewson had offered to take on the responsibility for village furniture which was currently not covered by a councillor.

## ■ 51 CORRESPONDENCE RECEIVED SINCE LAST MEETING AND CIRCULATED

- May 13: WLDC agenda for Annual meeting
- May 13: Revd Penny Green's Blog - for printing in **Sudbrooke News**
- May 13: LALC Weekly News
- May 15: News from Community Lincs
- May 16: Neighbourhood Planning Newsletter
- May 18: LALC Newsletter
- May 21: Reminder of Annual Resilient Communities Conference
- May 27: Pension Regulator News
- June 2: Bus timetable updates
- June 2: Report of damage to fence on Main Drive
- June 3: WYPF Pension News
- June 3: LALC Weekly News
- June 3: Report from resident re traffic along West Drive - forwarded to Contracts Manager, Jackson and Jackson Developments.

SUDBROOKE VILLAGE HALL MANAGEMENT COMMITTEE  
REGISTERED CHARITY NO. 504143

The Constitution of the Village Hall Management Committee provides for each village organisation to have a representative on the Committee. If any village organisation not currently represented wishes to appoint a representative please let me know via the Village Hall post box.

*Gill Rignall, Honorary Secretary*

# SUDBROOKE GARDENING CLUB

WITH JOHN & IRIS WHITAKER - 751198 and CORAL EVANS - 750031

## ■ CLUB OUTING TO RHS HARLOW CARR

► For the July outing, members and friends ventured north into Yorkshire to explore the delights of the Royal Horticultural Society's Gardens of Harlow Carr, located on the outskirts of Harrogate.

A garden with a wide variety of growing landscapes ranging from woodland to wild flower meadows. Members enjoyed a private guided tour of the garden, with expert knowledge being provided by volunteer Peter who inspired and delighted us all with insight into the garden's innovative designs, creative planting and practical ideas for us to take home! *Report by Angela.*

## ■ POTATO HORTICULTURAL CHALLENGE - THE WEIGH-IN

► At last... it was time to tip out the potato pots... the suspense had been immense and, unlike some members, most of us had not had a sneaky peak to see how the crop was fairing!

In March, everyone was given one seed potato and a pot in which to grow it, with instructions to meet again at an arranged date for a "weigh-in".

So the question was "who would be our supa dupa potato grower?"

All pots were lined up with name labels marking our prized crops.

John tipped them out individually and meticulously rifled through the compost to ensure that every last

pea-sized potato made it into the bowl for weighing.

There were whoops of joy as each of us was relieved to see that indeed there were potatoes under all that green foliage. Iris diligently recorded the weights and was able to give us our ranking in the great potato weigh off! Ironically, Ruth and Dave came first and second with weights of 946g and 813g respectively.

We say 'ironically' because it was they who had already peaked at their crop and had actually eaten three potatoes each before remembering that there was to be a social gathering for the weigh-in and not an individual tally!

They did in fact win by a good margin as we did not count their three naughty snacks. Their success we believe was a combination of the lovely warm wall at the rear of their home combined with the application of organic potato feed.

Everyone did very well and enjoyed delicious home-grown potatoes for dinner later.





# SUDBROOKE GARDENING CLUB

WITH JOHN & IRIS WHITAKER - 751198 and CORAL EVANS - 750031

## ■ VILLAGE HANGING BASKET COMPETITION – THE RESULTS

► A sincere thank you to Mandy and Scothern Nurseries for sponsoring this year's competition.

Three pairs of members from Sudbrooke Gardening Club perused all the hanging baskets around the village viewable from the public footpath and chose six finalists for Mandy to judge.

The weather conditions had not been favourable as there was an extreme hot spell for a few days followed by torrential rain. Well done to everyone who managed to keep their baskets in tip top condition.

The six finalists chosen were: 1 Chestnut Close, 11 St Edward's Drive, 7 Woolley Road, 16 Northfield Avenue, 18 Sibthorpe Drive and 13 Ellison Close.

Mandy chose James Bass' hanging basket at 16 Northfield Avenue as the winner and Michael Powell's hanging basket at 18 Sibthorpe Drive as runner-up.

Prizes will be presented by Mandy at the Village Autumn Show on September 9 and we hope you will be able to join us for a cuppa and to view the show exhibits.

## ■ AUGUST AGM

► This was held on August 12 at the home of Coral and Paul, whose garden was looking stunning and the vegetable patch was providing lots of nutritious produce, whilst fruit and vegetables for exhibiting at the Autumn Show were showing a great deal of promise.

At the end of the AGM, Ruth was presented with the Club's Horticultural Challenge Shield in recognition of her winning 946g potato yield. Throughout the club year there were four occasions when members brought along a single flower or stem from their garden and

points were awarded for all entries. Coral (with 11 points) was declared our winner for the second year running and was presented with the Club's Flower of the Month Trophy. In second place, with nine points was Angela, whilst Ruth came third with seven.

After dealing with general club matters, members partook of a cheese and wine supper whilst studiously attempting to solve the questions on Paul's latest quiz which was a masterpiece of computer generated artwork - thanks for all the brain exercise, laughter, stress and wine refills whilst teams attempted to beat the clock and answer as many of the 29 questions as they could.

With a score of 21 points each two teams shared the delicious chocolate prize - so congratulations to Team 1 (Beryl, Dave and Peter) and Team 2 (Kim, John and Angela).

## ■ TALLEST SUNFLOWER CHALLENGE

► During August we were busy photographing and measuring the sunflowers grown by members, as well as those grown by any villagers who made contact with us and wish their plant to be included in the challenge. A photographic collage will be on display at the Village Autumn Show and a trophy will be presented to the winner.

## ■ AUTUMN SHOW

► See page 3.

## ■ SPEAKER EVENING – “WORLD OF FERNS”

► With Neil Timm from the Fern Nursery, Binbrook Monday 14 October at 7.30pm in the Village Hall. Everyone is welcome to join us. Admission is £2.50 per adult which includes tea/coffee and biscuits. A raffle will be held.

# SUDBROOKE VILLAGE SIGN

WHEN Sudbrooke Scout Camp contacted the Carving Club at the end of 2014, we had no idea what adventure awaited us, writes Coral Evans.

We were offered a large oak tree trunk that had been struck by lightning and we were delighted. What an opportunity we thought, as we had never attempted anything three-dimensional!

We thought this would be a great opportunity and after much thought, we contacted the Parish Council to see if they

would like us to carve an artwork or sign for the village. Once agreed in principle, we needed to come up with a design.

After lots of ideas, we decided that an interesting and achievable theme would be the four seasons.

I drew some initial designs using everyone's ideas and then liaised with Helen Link, who previously ran Sudbrooke Carving Club. With Helen's help the current design evolved.

We needed to move the large trunk to somewhere we would be able to work on it, so with agreement from the Parish council and with generous help from Nigel and Andrew Wilkinson, a loader brought the oak to the Village Hall and was skillfully positioned for us to work on.

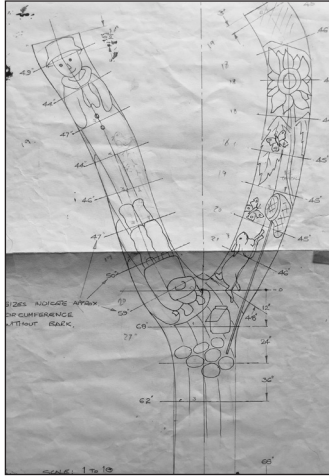

Previously the group had carved much smaller projects and we were lacking in large tools that would be required to shift a large volume of wood on the trunk. We filled in forms and applied for a grant through the West Lindsey Councillors Initiative Fund and were thankfully granted some funds for much-needed larger tools.

The first task was then to remove all the bark from the tree trunk to reveal the smooth wood below. The next task was to draw the design onto the tree

trunk and to do this we needed a scale drawing of the wood. We measured its circumference every foot and drew a 1 to

10 scale drawing that we could draw the design on. We then drew a grid onto the trunk and copied each one-foot section onto the corresponding space on the trunk. At last we were ready to carve! We soon

discovered that it was not going to be simple. Because of the three-dimensional element of the carving, you were not carving exactly what was drawn onto the wood and had to really think about what would be seen from different angles and carve accordingly.

You also needed to work on how each season would blend into the next as you walked around



# FROM INCEPTION TO FINISH



the tree. So, bluebell leaves blend into a river or snow and sunflower leaves blend into falling autumn leaves, snowballs look like frog spawn or pebbles on the riverside with Mr Hedgehog having a drink.

We took over a year to carve the first side, meeting every Monday morning for two hours. We enjoyed the challenge and the chit chat and always a nice cuppa at 11am with a biscuit or a piece of cake.

At this stage we contemplated whether we could raise funds for some fancy metal "SUDBROOKE" wording for across the centre and we again filled in forms for the West Lindsey CIF and were successful in obtaining another grant. David Payne from Spitfire Forge at Hall Farm, Harpswel, was generous enough to make the sign at cost and I was so impressed with his skill and artistic flair at the forge.

Nigel and Andrew then came to our rescue again and arranged for the trunk to be turned over using a JCB telehandler, so we could start the process of removing bark, drawing and carving all over again.

It took another year to carve the other side and we were quietly pleased with ourselves and the finished product; we had all learned a lot from the process. The trunk was then handed



over to the Parish Council and although it took some time to be erected due to the hurdles subjected by the highways department, I have to congratulate Chris Myers from the Parish Council for not giving up and getting a contractor to erect it on the Jubilee garden, where it looks very fine indeed and no worse for the wait and for personally arranging a small celebration to mark the achievement.

So, a thank you to everyone involved and a final thank you needs to go to my husband Paul, who kindly fitted the Sudbrooke metalwork and figured out how to get a long piece of metal into a smaller gap! and for putting up with me fretting on occasion as the project progressed.



®

## **Sudbrooke Village Store**

**on Holme Drive, Sudbrooke** - is incorporating a Post Office into the business from 25<sup>th</sup> March 2019. With so many Post Offices being closed in the last few years this sure is good news.

### **Opening times will be:**

**Monday to Friday 07.00 – 19.00,**

**Saturday 07.30 – 19.00,**

**Sunday 08.00 – 17.00**

### **Services Available:-**

#### **Mail**

First and Second Class mail

Stamps, stamp books (1<sup>st</sup> Class 6 and 12 only, 2<sup>nd</sup> class 12 only)

Special Stamps (Christmas issue only) and postage labels

Signed For, Special Delivery

Home shopping returns

Inland small, medium and large parcels, Express and contract parcels

British Forces Mail (BFPO)

International letters and postcards (Inc. signed for and Airsure)

International parcels up to 2kg and printed papers up to 5kg

Articles for the blind (inland and international)

Royal Mail redirection service

Local Collect, Drop and Go

#### **Withdrawals, deposit and payments**

Post Office Card Account

Personal and Business Banking cash withdrawals, deposits and balance enquiries using a card, also enveloped cheque deposits and barcoded deposit slips.

Post Orders, Moneygram

**Bill payments** - Automated bill payments (card or barcoded)

Key recharging

**Travel** - Pre-order travel money, Travel insurance referral

Mobile Top-ups and E Vouchers

---

# PUBLIC MATTERS

WITH DISTRICT COUNCILLOR BOB WALLER



## WEST LINDSEY STATS AND FACTS

► The School holidays are coming to an end and so is the summer weather, I think we have had a typical summer this year, but fingers crossed that we get some sun before autumn arrives. The council has been quiet this month with members and officers taking their summer holidays.

I attended the Local Government Association conference last month and was disappointed and surprised that quite a few of the other delegates I spoke with had not heard of West Lindsey. I think we must promote ourselves more as this is a lovely part of the country and a great place to live and work. I have also been speaking to other residents and again discovered that some facts about our district are not widely known. So, I thought I would just detail a few interesting statistics.

West Lindsey is one of the largest districts in England, covering an area of 447 square miles. It has 20 wards and 97 parishes. Weekly earnings are higher than the regional average, with a higher percentage of managers, professionals and skilled tradespeople.

While the average house price in the district has increased to record levels, the affordability ratio remains static and is worse than the national average. Access to superfast broadband has improved significantly over the last year with 88% of households now connected.

The population of the district is 94,869 (Sudbrooke and Scothern account for 2,720 of these) with an average age of 47, which is seven years higher than the national average. Approximately 56,600 of the population are of working age. Child obesity levels in the district

have fallen for reception children (aged 5-6). However, the picture worsens for children by the age of 11 where the figure stands at 17.79%. This figure is the lowest in the region and lower than the national average of 19.8%.

Life expectancy in the district is slightly above the national average. Child poverty still exists in the district (as it does across the country) Gainsborough South West Ward has the highest percentage in the district and Sudbrooke Ward the lowest.

West Lindsey has a good record on educational attainment, 0.9% below the national average at level 4 and above and 4.6% above the East Midlands average. Manufacturing is still the leading sector for jobs at 16% followed by Health and Social Work at 12% of the workforce. A further 9.4% of workers are self-employed, slightly lower than the national average of 10.6%.

Crime in our district has increased slightly. The major crimes are shoplifting, burglary and criminal damage. Drug offences are relatively low.

Tourism brings in around £10m a year, but the district has some difficulty in that it competes directly with Lincoln and East Lindsey and cannot offer a sizable city or seaside resort. In terms of sport and leisure, the district has an abundance of grass pitches, tennis courts and golf courses. We also have the Showground and the racecourse at Market Rasen. However, it has fewer of other facilities given the population. Work on the new Market Rasen leisure centre has now got underway.

Whilst I appreciate that not everyone will agree with me, I believe we live in a great area with further potential to make it an even better place to live and work.



# SUDBROOKE GARDENING CLUB AUTUMN SHOW

To be held in the Village Hall on Monday 9 September, 2019

## RULES

- 1) Adult entries into the Village Show are welcome from any adult or young person aged 15+ residing in Sudbrooke and all members of the Gardening Club.
- 2) Junior entries are encouraged from all children aged 14 years and under, either residing in Sudbrooke or with connections with the village, ie. grandchildren and local schools.
- 3) All entries must have been grown or made by the exhibitor.
- 4) Winning entries from previous Shows may not be re-exhibited.
- 5) Adults may enter a maximum of two exhibits per class.
- 6) Juniors may enter a maximum of two exhibits per section in Class No. 40.
- 7) Adults will be charged an entrance fee of 20p per exhibit.
- 8) Juniors may enter free of charge. Age to be shown on exhibit.
- 9) All items are left entirely at the owner's own risk.
- 10) Between 6pm and 7pm exhibits must be displayed on the tables provided for each class, ready for judging from 7.05pm.
- 11) Points will be awarded in each Class as follows:
  - 1st place 3 points**
  - 2nd place 2 points**
  - 3rd place 1 point.**
- 12) Place cards will be awarded for each class 1st, 2nd or 3rd places.
- 13) Gift vouchers will be awarded to category winners.
- 14) A trophy will be awarded for the 'Best in Show' exhibit. The exhibitor will hold the trophy until the next Show.
- 15) A trophy will be awarded to the adult exhibitor scoring most points overall. The exhibitor will hold the trophy until the next Show.
- 16) A trophy will be awarded to the junior exhibitor scoring most points in the show. The exhibitor will hold the trophy until the next show.

Tea, coffee, soft drinks and biscuits are available from 7pm.  
Open for public viewing from 7.45pm - no charge for viewing.

## NAME.....

*Open to Sudbrooke Residents and Gardening Club Members*

## ENTRY FORM

### VEGETABLES

- 1 Six Runner Beans.....
- 2 Four Tomatoes.....
- 3 Three Onions.....
- 4 Three Courgettes .....
- 5 Three Beetroot.....
- 6 One Vegetable and One Flower .....
- 7 One Table Marrow or Pumpkin .....
- 8 Longest Runner Bean (irrespective of quality).....
- 9 Three Shallots.....
- 10 Three Parsnips.....
- 10a Three Carrots.....
- 11 Three Leeks.....
- 12 Three Vegetables in a Box .....

### FRUIT

- 13 Soft Fruits in Season .....
- 14 Three Dessert Apples .....
- 15 Three Cooking Apples.....
- 16 Three Pears .....

### FLOWERS/POT PLANTS

- 17 One Spike Gladioli .....
- 18 Any Three Dahlias.....
- 19 One Hybrid Tea Rose .....
- 20 One Stem Floribunda Rose.....
- 21 Any Three Stems of any Perennial .....
- 22 One Spray Chrysanthemum .....
- 23 Any Three Asters .....
- 24 One Vase Mixed Flowers - minimum four varieties.....
- 25 One Flowering Pot Plant .....

- 26 One Foliage Pot Plant .....
- 27 One Cactus.....
- 28 One Succulent .....

### FLOWER ARRANGEMENT

- 29 'Flowers from the Garden'.....
- 30 A Foliage Arrangement .....

### MISCELLANY

- 31 Any plant for exhibition not included in classes 1-30 .....
- 31a "What went wrong!" - flower, fruit or vegetable .....

### COOKERY

- 32 Jams or curds.....
- 33 Chutney.....
- 34 Fruit Pie .....
- 35 Savoury Flan.....
- 36 Four Fruit Scones.....
- 37 Cake using Garden Vegetable (state vegetable used).....

### HANDICRAFT

- 38 Handicraft - any medium .....
- 39 Photography - 'In the garden'.....

### JUNIOR SECTION: (AGE 14 AND UNDER):

- 40 Section A: Something I have grown .....
- Section B: Something I have made .....
- Section C: Something I have cooked .....
- Section D: Something I have painted, drawn or photographed about Autumn..

# SUDBROOKE WALKING CLUB

WITH MIKE HALLIDAY - 01522 754686

## ■ AUGUST WALK

► As the weather was very hot, walkers decided a more leisurely walk was appropriate so opted for a six-mile stroll around the Ingham village area where the terrain is fairly flat and the fields dry underfoot.

Ingham village has a good mix of old and new property types and always seems to have a welcoming aura about it.

Our walks from the village always seem to coincide with coffee mornings or other fund raising activities at the village hall.

The vast fields of wheat and barley were a delight to see in the bright sunshine.

## ■ SEPTEMBER WALK

► Regular walkers have opted for the seven-mile walk around the Temple Bruer area, but in a reverse direction.

The terrain is flat and usually dry underfoot.

Walkers should meet at the village hall at 9-30am and are advised to take a waterproof coat, wear suitable footwear and bring a drink and a snack.

Everyone is welcome to join the walk.

For information our coastal walk this year is the October walk of approximately seven miles and is from Cleethorpes taking in the Fitties and coastal dunes.



# Sudbrooke Gardening Club Members invite you to a Speaker Evening

(Open to everyone with an interest in gardening)

# World of Ferns

**“There is a fern for every place in your garden”**

**Speaker: Neil Timm**

**(from the Fern Nursery, Binbrook)**



**Monday 14 October**

**Sudbrooke Village Hall at 7.30pm**

**Admission: £2.50 (including refreshments)**

**Raffle**

**A lucky member of the audience will be presented with a surprise gift**

Tel: 01522 751198 for further information

[www.goodlittlepartyfood.co.uk](http://www.goodlittlepartyfood.co.uk)

[enquiries@goodlittlepartyfood.co.uk](mailto:enquiries@goodlittlepartyfood.co.uk)

[facebook](#) and [instagram](#): Good Little Party Food and My Favourite Cake Company  
0789 6211 513

**beautiful cakes for all your special occasions**

**party food for your celebrations**

**catering for your corporate events**

**take home treats for your party bags**

**enquiries for displays, talks and tutored events welcome**

**delivery by prior arrangement**

**Cake Artist and Caterer**

**Nicola**

**HADLEY**



a food business registered with West Lindsey District Council  
5 star hygiene rating and many excellent references





# A PENSIONER REMINISCES:

Before we set sail for Corfu, we took advantage of a free night's stay at a Roman amphitheatre just south of Igoumenitsa. They'd stopped charging to get in about 2000 years ago, so no chance of me having to pay for a night's stay! We had it all to ourselves. Next morning we rose early and made our way down to a port already bustling with activity, and sought to find our boat amongst the chaos that always exists around a port.

But this was a Greek one, and you had to be psychic to know which was the one you required. With no-one speaking English, and no office to give information, I just had to muddle through as best as I could. I finally found it (it was the first one I spotted),

and we drove on to two planks spanning the shore and the deck (they were big planks). The only other vehicle was an old Mercedes lorry of dubious vintage from pre-War times at least. I think there was a picture of me on the deck with my youngest daughter in last month's issue. There was a small bar from which you could get food and drink and I remember having our first ever cheese toastie. Marvellous!

I don't remember docking, but it wasn't long before we were lost in the old town of Corfu! We drove down a certain street that inevitably became narrower and narrower until finally we could go no further without the irate shopkeepers having to remove their wares to let us through. Embarrassing to say the least. But it's happened before, and with a smile and a wave we got through with a minimum number of death threats! So where to next?

Having bought some supplies, we were well stocked up, and we headed north on the coast road, wanting to get out of Corfu town as soon as possible. We spotted a camp site at Dassia, not many miles out of town, and we pulled in to the site which was on the opposite side of the road to the beach. There followed three days of rain which we didn't travel 2,000 miles for, and the site became quickly waterlogged. Having to cross a main road to get to the beach seemed like a bad idea anyway, so we moved a little further north to Barbati, and set

up camp in an olive grove just off the beach, true gypsy style.

It was mid-May and the weather was improving, so it was time to do some chores and washing was high on the list. Water didn't last



**We had a 12-volt video player for times when we were travelling**

us very long and I was always on the hunt for it when there was no tap. My usual ploy was to call in to a petrol station and buy some fuel, and fill up from a tap. The second problem was getting the toilet emptied. With six people on board it needed to be done every two or three days. All the waste material was collected in a detachable tank which just fitted into my rucksack. Having filled up with water, I would lower it from my back (with great care) in the nearest toilet and empty it down the loo. I used a special green chemical to make this safe (you campers will know what I'm talking about).

We stayed at Barbati Beach for almost a week enjoying the sunshine and the free and easy lifestyle. As we are a family of waterskiers, we teamed up with a local guy that had a ski boat on the beach, where we drummed up business for him in exchange for trips out



# A TALE BY TERRY MAYO

behind the boat. We also had the opportunity to parasail which the children enjoyed immensely. It was from this campsite that I set out to climb Mount Pantokrator, the highest mountain on Corfu. On a boiling hot day I couldn't get a drink, and ended up being quite dehydrated. Lesson learnt!

We said 'antio sas' to our boat driver friend, and headed across the mountains to the west side to Paleokastritsa, which is a very rocky resort, quite different to Barbati. It was a little walk out of town, but this time it had some facilities, and I didn't have any water collecting problems or toilet trips to make. Also there was a small shop on site, not that we needed much as the vast majority of stuff we took with us. We always found things to do and the children were always happy.

We had a 12-volt video player for times when we were travelling, as well as a 12-volt television, and loads of video tapes. They watched them when we were on the road as well as on rainy days. The TV was built in, so no fear of it falling out! We rarely ate out, I think the children were happier that way. Mum's cooking was 'safe'. But we did find that 'Lewis De Frise' moment one day. We were driving back to the site one evening and saw a sign for a small vineyard called 'Contis'. We went in to have a look, and Mr Conti was offering tasting. He led us all into a small vine covered courtyard to a table and offered some wine to taste. Before long in this little restaurant, he was serving up the most

spectacular meal we'd ever had. Mutton stew in a pot with gravy, large stuffed tomatoes filled with vine leaves, and garnished with a bunch of black grapes. Chased down with a bottle of vintage retsina. I'd found my Lewis De Frise moment!

But it was time to point the vehicle home and say 'antio sas' to Corfu. I have no

recollection of the ferry back to Greece save seeing the black mountains of Albania only one and a half miles away, and being followed by a gunboat from this forbidden land for a short distance. We'd come all the way down through central Yugoslavia, but were minded to come back up the coast from Dubrovnik up to Split. I remember seeing the islet of Svety Stefan out in the Adriatic as we skirted Albania, much to the mirth of the kids. We

came to the beautiful city of Dubrovnik, before the war damaged it so badly (but has now been repaired) and stayed there for a day, before moving up the coast to Split following the coast road all the way. There were signs of the communist government everywhere and although Dubrovnik was spectacular, there was nothing else that impressed me very much. In Split, there were large posters depicting Marshall Tito.

Back on the main road I did stop for some bread at one point at a shop surrounded by some unsavoury characters (it was probably me being over careful) and we were back to Ljubljana and heading north to Austria.



# THE CHURCH DIARY

WITH REVD PENNY GREEN - 01522 595596 [slbchurches@virginmedia.com](mailto:slbchurches@virginmedia.com)

## ■ SENT TO COVENTRY!

► We have a fantastic cathedral in Lincoln. Coventry Cathedral is wonderful too, not quite the architectural match of Lincoln (in my humble and very biased opinion), but it has an amazing ministry of reconciliation. They have this notice at their entrance:

### A Cathedral Welcome

We extend a special welcome to those who are single, married, divorced, widowed, gay, confused, filthy rich, comfortable or dirt poor.

We extend a special welcome to wailing babies and excited toddlers.

We welcome you whether you can sing like Pavarotti or just growl quietly to yourself. You're welcome here if you're 'just browsing', just woken up or just got out of prison. We don't care if you're more Christian than the Archbishop of Canterbury, or haven't been to church since Christmas 10 years ago.

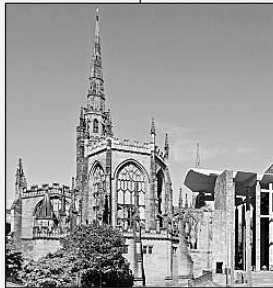

We extend a special welcome to those who are over 60 but not grown up yet, and to teenagers who are growing up too fast. We welcome keep-fit mums, football dads, starving artists, tree huggers, latte-sippers, vegetarians, junk-food eaters. We welcome those who are in recovery or still addicted. We welcome you if you're having problems, are down in the dumps or don't like 'organised religion'. (We're not keen on it either!).

We offer a welcome to those who think the Earth is flat, work too hard, don't work, can't spell, or are here because granny is visiting and wanted to come to the Cathedral.

We welcome those who are inked, pierced, both or neither. We offer a special welcome to those who could use a prayer right now, had religion shoved down their throat as kids or got

lost in the city centre and wound up here by mistake. We welcome pilgrims, tourists, seekers, doubters ..... and you!

Not exhaustive but you get the drift!!

# CHURCH SERVICES DATES FOR LOCAL CHURCHES

## SEPTEMBER

Sun 8	Barlings	9.15am	Holy Communion
Mon 9	Sudbrooke	9am	Morning Prayer
Tue 10	Sudbrooke	9am	Morning Prayer
Thu 12	(01522 753119)	2.30pm	Tea Service
Sun 15	Langworth	9.15am	Holy Communion
	Sudbrooke	10.45am	Morning Praise
Mon 16	Sudbrooke	9am	Morning Prayer
Tue 17	Sudbrooke	9am	Morning Prayer
Sun 22	Sudbrooke	10.45am	Holy Communion

Mon 23	Sudbrooke	9am	Morning Prayer
Tue 24	Sudbrooke	9am	Morning Prayer
Thu 26	(01522 753119)	2.30pm	Tea Service
Sun 29	Langworth	10am	Group Communion

# THE SADBROOKE LOCAL

— DATES FOR YOUR DIARY —

**QUIZ NIGHT**

**SEPTEMBER**

**13**

**OCTOBER**

**11**

**NOVEMBER**

**8**

**DECEMBER**

**13**

**The Village Hall bar opens at 7.30pm,  
with the quiz starting at 8.15pm**

# SUDBROOKE SENIORS

We are a group of people aged over 55 years who meet each month for coffee and a chat. New members are always welcome so why don't you come along and join us.

There will probably be someone there that you know!



**WHERE?** Sudbrooke Village Hall

**WHEN?** The second Friday of each month at 10.30am

## SUDBROOKE VILLAGE HALL

REGISTERED CHARITY NO. 504143

Sudbrooke Village Hall, the Bramham Lounge and bar are available for hire.

If you book the Bramham Lounge or bar area for a meeting/training course you can make use of FREE WiFi.

These areas are suitable for smaller groups and meetings.

A slide/projector screen is now available. Please ask for details when booking

The hall is situated next to the village playing field and play area, making it a very pleasant venue for children's parties, wedding, christening and

birthday parties. The modern commercial style kitchen makes the hall even more attractive as a venue for large functions when catering is required.

The well stocked bar with draught beers can be booked with either the main hall or the lounge.

Further information: Sudbrooke Parish Council website: [parishes.lincolnshire.gov.uk/Sudbrooke/](http://parishes.lincolnshire.gov.uk/Sudbrooke/)

Enquiries: Dave Rowley, Booking Secretary, 07539 604258.

**NEW EMAIL BOOKING ADDRESS**

[sudbrookevillagehall.bookings@gmail.com](mailto:sudbrookevillagehall.bookings@gmail.com)

# POETRY BOX

## WHEN SUMMER'S END IS NIGHING

When summer's end is nighing  
And skies at evening cloud,  
I muse on change and fortune  
And all the feats I vowed  
When I was young and proud.

The weathercock at sunset  
Would lose the slanted ray,  
And I would climb the beacon  
That looked to Wales away  
And saw the last of day.

From hill and cloud and heaven  
The hues of evening died;  
Night welled through lane and hollow  
And hushed the countryside,  
But I had youth and pride.

And I with earth and nightfall  
In converse high would stand,  
Late, till the west was ashen  
And darkness hard at hand,  
And the eye lost the land.

The year might age, and cloudy  
The lessening day might close,  
But air of other summers  
Breathed from beyond the snows,  
And I had hope of those.

They came and were and are not  
And come no more anew;  
And all the years and seasons  
That ever can ensue  
Must now be worse and few.

So here's an end of roaming  
On eves when autumn nighs:  
The ear too fondly listens  
For summer's parting sighs,  
And then the heart replies.

By  
AE Housman

Wagon House  
Teashop at



**A friendly family run teashop serving delicious home  
-cooked food; lunches, scrumptious cakes and more.**

Located at the entrance to the beautiful 4.5 acre Goltho  
Gardens.

Goltho Gardens | Lincoln Road | Goltho | Nr Wragby | LN8 5NF  
01673 857814 | [www.golthogardens.com](http://www.golthogardens.com)

# SUDBROOKE LADIES CLUB

WITH GILL RIGNALL - 01522 595736

## ■ LATEST MEETING

► Members enjoyed a trip to the Petwood Hotel at Woodhall Spa for the summer lunch.

Former committee member Molly Preece is leaving the village. We wish George and Molly all the best in their new home near family.

We are sorry to note that our associate member, Eleanor McCulloch, and previous member, Cathy Eaton, have passed away. Our thoughts are with their families.

## ■ FUTURE MEETINGS

- Thu 19 Sept: Ghost walks-Karen Crowe.
- Thu 17 Oct: Members' evening.

We meet in the Bramham Lounge at the Village Hall at 7.30pm. All welcome. Guests are asked to contribute £2.

The club has been successful for many years. Sadly, membership has dwindled. Ill health and low numbers have made it difficult to continue. The club will be closing at the end of the year after our Christmas lunch.

Funds are available if anyone wishes to re-form a Ladies' group.

The full 2019 programme is available on the website: <http://parishes.lincolnshire.gov.uk/Sudbrooke/>

Further information: 01522 595736

# READERS' LETTERS

## YOUR CORRESPONDENCE

### ■ A LOVELY SCENE

*Dear Editor,*

I just had to share this wonderful moment with someone and possibly with your readers.

It is August Bank Holiday, the most wonderful hot summer's afternoon. Traffic on Wragby Road is racing by in both directions and very heavy. As I walk, I see vehicles trying to leave Scothern Lane having to wait ages to exit.

Walking my little rescue doggie, I made my way to the children's playground just off Holme Drive on my way to the woods. I then saw a sight which amazed me. I have not seen this sight for at least 25 or so years and certainly never in our village. I bet you haven't either.

On the neatly cut grass alongside the fenced off playground, I saw a family having a picnic seated on a red tartan rug with a white table cloth on top of it heaped with a Thermos flask, a lovely large iced sponge cake and plates heaped with sandwiches and biscuits as well as

bottles and glasses containing coloured drinks. The family consisted of three small children of seven years or so and both their parents.

They looked and sounded so happy. I sat on the nearby memorial bench seat about 30 or so yards away without intruding on them, but casually watching and soaking in the pleasure they were exhibiting. I thought to myself how idyllic this was and just how little it could have cost both financially and in time.

No spending hours in traffic queues and having to find a parking space miles away. It was all here in our village yards away. When did you last have a full laid out picnic seated out in the open air? Like me you have almost certainly been missing out and it is so simple to arrange.

I made my way home and sat down with a pot of coffee to watch that wonderful cricket Ashes Test victory over Australia. Just amazing. That rounded off a perfect day.

*Peter Nuttall*

# READERS' LETTERS

## YOUR CORRESPONDENCE

### ■ A SENSE OF COMMUNITY?

Dear Editor,

It is here in Sudbrooke... come and join in! I have seen articles in **Sudbrooke News** about the lack of community spirit and activities in our village.

Well, good news. I am sure there are lots of small groups that help each other along in Sudbrooke, from mums chatting at pre-school and at the school gate, to the kids' fun day each year, as well as other clubs and activities advertised in **Sudbrooke News** that continue to try and nurture community spirit here.

Sudbrooke Gardening Club is one of the latter and they run two village shows each year on behalf of Sudbrooke residents. You don't need to be in - or even want to be in - the Gardening Club to go along to the Autumn Show. You can turn up on September 9 at 7.45pm to browse the arts, crafts and gardening produce that folk have entered into the Show. Or why not come a little earlier at 7pm and enjoy a cup of tea or coffee and a biscuit and have a chat with fellow residents? A strong sense of community is clear to see with happy smiling faces and laughter.

If you do fancy entering exhibits yourself, then the Rules and Entry Form are advertised in this magazine before each show. Every entry has the chance of winning the Best in Show Trophy and prize. All children's entries receive a certificate of commendation and there are sweeties to share.

The Gardening Club also host two Speaker Evenings each year at the Village Hall, and these are also open to everyone to attend. Put the dates in your diary - Autumn Show on Monday 9 September the Speaker Evening on Monday 14 October, followed by another Speaker Evening on Monday 9 March, and the Spring Show scheduled for Monday 20 April 2020.

Coral Evans

### ■ AND THE SAME TO YOU

Dear Editor,

This morning, September 4, I was walking my dogs along Elm Drive towards Manor Drive. A car left the shop car park and passed me as one of my dogs was doing a poo, like they do.

I noticed that the car had stopped close to the junction before reversing a short way and stopping again in the middle of the road.

As I drew level, the 'lady' driver called out: "Excuse me, did you pick your poo up?"

It was too early in the morning for my brain to think of a good answer quickly, but I offered her the compostable bag and its contents.

"Okay," she said, as she drove off. Many years ago, my neighbour phoned to ask if I allowed my dogs to defecate on the grass verge, because her taxi driver had trod in some poo on the verge at the front of my house.

I am an old moaner, but draw a line at being narrow minded like these two. I think the expression is "get a life!"

*Name and address supplied*

### ■ SIGN OF THE TIMES

Dear Editor,

How wonderful a work of art that new carved village sign is in the wild flower garden on the green by the Millennium Stone.

The wild flowers are now well established there and make a great show with handsome signposts.

The one thing that is missing though are red poppies. They would really round the display off. At present there are none... any chance of planting some?

Poppies mean so much as memorials and are so colourful. Please ask the Parish Council to consider it.

Mary Brown





# SUDBROOKE Village Store Ltd



Newspapers • Magazines • Milk • Bread  
Cereals • Coffee • Tea • Sweets

Wide range of wines • Spirits • Beer  
Payzone • National Lottery • Birthday cards

## Tel: 01522 754234

### 1-2 Holme Drive, Sudbrooke LN2 2SF



## B Knight & Son Ltd

Timber Merchants & Manufacturers



Gates, Fencing, Garage Doors,  
Automated Gate Systems,  
Aged Decorative Oak Timbers,  
Hardwoods, Treated Softwoods,  
Decking, Cabins, Garden Furniture,  
Sheet Materials, Tools & Firewood.

All Enquiries Welcome.

t: 01522 754207

f: 01522 754204

e: [sales@b-knightandson.co.uk](mailto:sales@b-knightandson.co.uk)

[www.b-knightandson.co.uk](http://www.b-knightandson.co.uk)

30 Main Road, Langworth, Lincoln, LN3 5BJ

Bringing Timber To You Since 1874



## Spinney Handyman

Based in Cherry Willingham

General property maintenance,  
plumbing and decorating

No job to small

Free no obligation quote

Adam - 07402 773622

[spinneyhandyman@gmail.com](mailto:spinneyhandyman@gmail.com)

Fully insured

# INFORMATION STATION

## WHO, WHERE, WHEN AND WHAT

### EMERGENCY SERVICES

Emergency .....	999
Police.....	101
Fire & Rescue .....	01522 582222
Ambulance Service .....	08450 450422
PSCO Jackie Parker .....	07973 842368

### WEST LINDSEY DISTRICT COUNCIL

Main number.....	01427 676676
Out-of-hours.....	01427 613960

### ENVIRONMENT AGENCY

Flood line .....	0845 988188
Incident hotline.....	0800 807060

### LINCS COUNTY COUNCIL

Main number.....	01522 552222
Emergency planning.....	01522 582220

### HEALTH SURGERIES

Nettleham Health Centre .....	01522 751717
Welton Health Centre.....	01673 862232

### SCHOOLS

Sudbrooke Pre-School .....	753938
Ellison Boulters.....	01673 862392
William Farr .....	01673 866900
Cherry Willingham .....	01522 751040
Scothern After-School Club .....	07944 709024

### UTILITY COMPANIES

Electricity Central Networks.....	0800 6783105
Gas - National Grid .....	0800 111999
Anglian Water .....	08457 145145
Severn Trent Water .....	0800 7834444
Yorkshire Water .....	0800 1573553

### NETTLEHAM LIBRARY

Opening Times .....	01522 782010
Tuesday-Friday: 1-5pm	
Saturday: 10am-12noon	

### WHAT'S ON IN SUDBROOKE AND SCOTHERN

25th Lincoln Scouts.....	753689
1st Scothern Brownies .	<a href="mailto:scothernbrownies@hotmail.co.uk">scothernbrownies@hotmail.co.uk</a>
Sudbrooke Seniors.....	750852

### HOME SECURITY ADVICE

### SUDBROOKE PARISH COUNCIL

#### Clerk to the council:

Mrs C M Myers, 94 Jubilee Close, Jubilee Park,  
Cherry Willingham LN3 4LD .....750531  
Email: [SudbrookeParishCouncil@gmail.com](mailto:SudbrookeParishCouncil@gmail.com)

#### Chairman:

Peter Heath..... 595061

#### Vice-Chairman:

Bob Waller.....753017

#### Members:

Lyn Etheridge .....	750905
Paul Rignall .....	595736
Ian Russell.....	754984
Andrew Cottam .....	750470
Mike Turnbull .....	752245

#### Treasurer:

Bridget Solly..... 01673 857580

#### County Councillor:

Sue Rawlins, Badgers Holt, Friesthorpe Road,  
Buslingthorpe .....

#### District Councillor:

Bob Waller (also Parish Cllr).....753017  
Email: [cllrrwaller@gmail.com](mailto:cllrrwaller@gmail.com)

### MEMBER OF PARLIAMENT

Edward Leigh, 20 Union Street, Market Rasen  
LN8 3AA..... 01673 849461  
Email: [gcca.uk@btconnect.com](mailto:gcca.uk@btconnect.com)

### SUDBROOKE VILLAGE HALL HIRE

Dave Rowley..... 07539 604258

### CLERGY

Reverend Penny Green .....

**IF YOU WOULD LIKE TO BE  
FEATURED ON THIS PAGE, THEN  
EMAIL [sudbrookeneews@gmail.com](mailto:sudbrookeneews@gmail.com)**

Ladies Club.....595736

Dave Cook.....422706

